

WASHING MACHINE → GREENS SPINNER CONVERSION SOP

Model Reference: Whirlpool WTW5010LW0

DISASSEMBLY PROCEDURE

1. Cut the bottom of the box and remove.
2. Remove tape and any shipping blocks or other materials from the drum. Plug the machine in and confirm operation using a spin cycle. Unplug.

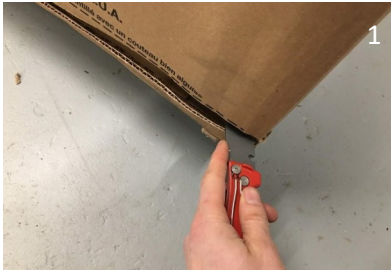

3. Unclip the drain from the back panel.
4. Remove the screws on the back of the washer to remove the back panel (1/4" socket or nut driver). *(Exact locations may differ from picture)*
5. Lift up on the back panel to remove it.

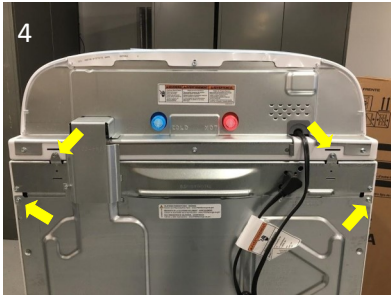

6. Ensure power is disconnected. Then, cut off the power cord. *(This can be used later)*



7. Cut off the tubing and wires from the control panel (they are not needed).

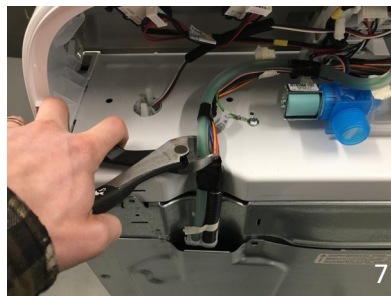

Tools Needed

- 1/4", 5/16" & 11mm sockets or nut drivers
- Flathead & Phillips screwdriver
- Wire cutters
- Wire Strippers
- Channel-lock pliers
- Needle Nose Pliers
- Impact or drill driver
- 1/4" Drill bit and drill

Materials Needed

- Timer switch & Waterproof electrical box
- Wire nuts
- Electrical Tape, Zip ties
- Waterproof Cord Connector / Grommet (2)
- Power cord (8' of 14-3)
- 1/4"x1/2" Self-tapping screws (4)
- 2.5" Corner brace (1)
- 3.5" Deep Rubber Bumpers (3) *(Optional)*
- Stainless 5/16" x 3.5" Nuts/bolts (6), washers (12) *(Optional)*
- 1" Spacer (1/2" PEX works well) *(Optional)*

8. Lift off the top of the washer starting from the back, lift up and push forward slightly to unhook it.



9. Use a screwdriver to remove the plastic splash guard around the top of the drum. *(There are 8 points of attachment, after unhitching ~1/2 you can just pull up on the ring).*

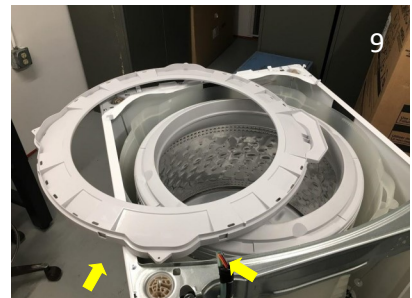

10. Tilt washer on its front face (*Use the cardboard to not scratch the paint, scratches lead to rust and rough metal which is hard to clean.*) Remove the bottom packaging material.



11. Remove hose clamp from the basin. (*This hose clamp was blue*)



12. Unclip a door to revealing the wire to the pump. This can be unplugged.

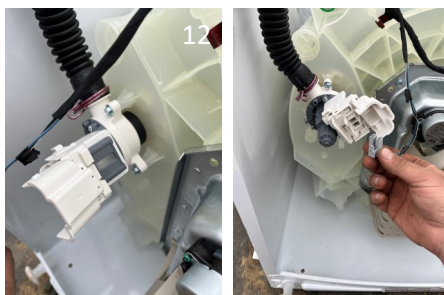

13. Remove the pump and drain tubing by removing (6) 5/16" screws.



14. Cut off the plastic elbow from the longer drain tube and connect the drain tube to the bottom of the drum.



15. If needed secure the drain hose using zip ties to drain away from the motor.



16. Pull out pins holding the wiring harness (needle nose), remove all zip ties and tape.



17. Remove the Clear tubing along with the wiring harness. There are some wires inside this harness that will be used.



18. The freed wiring harness from the chassis.

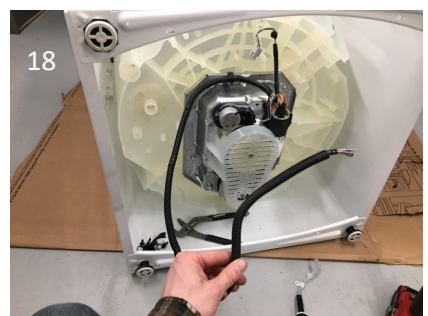

19. Cut the last zip tie but leave the connector on the bottom of the machine.

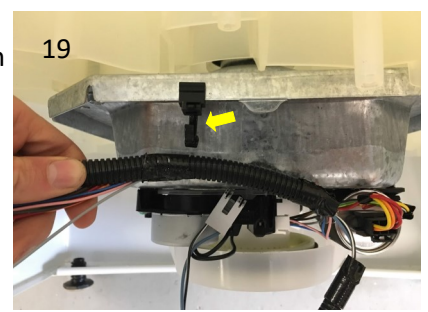

20. Split the cable wrap and extract the wires.

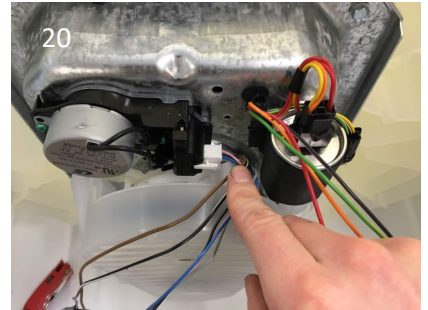

21. Remove the connector and wires from the synchronous motor. These wires are not needed.



ELECTRICAL PROCEDURE

1. Follow the wiring diagram on the last page of this document.

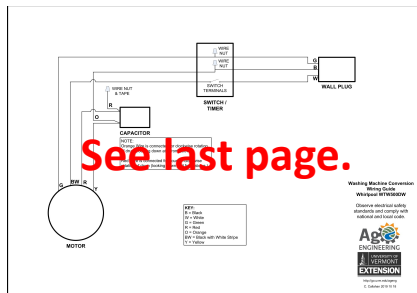

2. Take the wires coming from the motor and cut them about a hand length long. These are the ones you need to tap into with the switch.



3. Decide if you want clockwise or counterclockwise rotation (when looking down at the drum). You will use the RED wire for clockwise rotation, or ORANGE wire for counterclockwise rotation. Cut off 6" of the wire you will not use. Fold it over and tape it to prevent shorting.



4. Cut off 8' feet of electrical plug wire.



5. Strip the wires from one end of the cord and the three wires going to the motor.

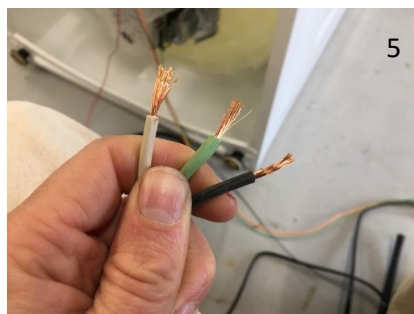

6. Connect the wires using wire nuts.
 - Green to Green
 - Orange (or Red) to Black
 - Black/White stripe to White.
 [See wiring diagram]



7. Turn the machine upright and mount a 2.5" corner bracket to the side of the appliance using 1/4" self-tapping screws. This can be mounted anywhere, but consider where the machine will be located and select an comfortable ergonomic spot (e.g. see Photo #12).



8. Mark the holes in through bracket and drill a pilot hole in the box. Secure using self-tapping screws.



9. Install the cord fittings to the waterproof box and insert the cord from the motor wires, and the appliance power cord into the box, do not pinch the wire down in the connector just yet.



10. Wire in the Switch!
 - White to White
 - Green/Green/Copper
 - Black-Switch-Black
 [See wiring diagram]



Wiring the Switch

- a. Strip the ends of both cords once passed into the box.
- b. Use the 6" of wire from the unused wire to use as a jumper.
- c. Connect the jumper and both grounds (green) with a wire nut, then connect the ground from the switch (copper) and the jumper to the screw in the box.
- d. Connect White to White with a wire nut (On the power cord it's the side with lettering)
- e. Each black goes to either side of the switch/timer

11. Carefully tuck the wires in the box, install the knob, connect power and test for spinning!



12. Disconnect power and carefully mount the switch in the box.



13. Secure both cord connectors to secure the cables coming in and out of the box.



14. Install the faceplate to the timer.



15. Lay the machine back down and begin to wrap the wires from the motor with electrical tape. Start with one wire nut before wrapping the rest.

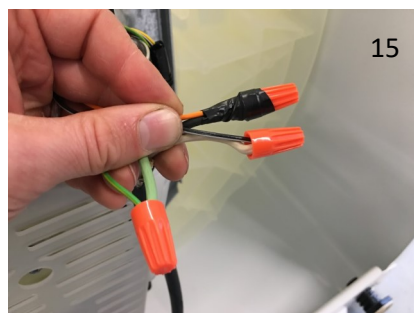

16. Next add the second wire nut then the third to keep them separated and to create a sturdy and sealed connection.



17. Carefully loop this cable to not strain or kink any of the wires. Secure with zip-ties back to the machine using the previous wiring harness tab.



18. Use zip-ties to secure the rest of the wire to the side panel of the chassis through the previous screw holes.

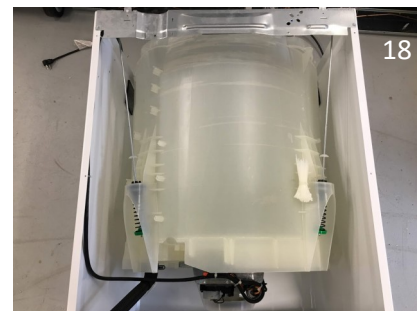

INSTALLING BASKET BUMPERS

1. Remove the drum by removing the cap, 11mm bolt under the wash plate, then use a spanner wrench to remove the nut holding in the drum.

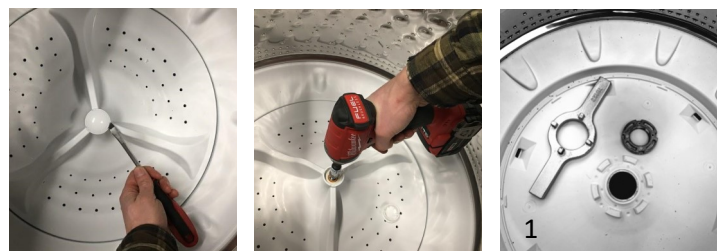

2. Align the bumper positions up with the wash plate and mark the location of the holes to mount the bumpers. Drill a 5/16" hole in each location.



3. Install the bolts from the outside of the drum, add 1/2" spacer, bumper, and install the nut inside the bumper on top of a washer.



Andy Chamberlin, UVM Extension
Chris Callahan, UVM Extension
Adam Buggy, Northwest Corner Farm

ageng@uvm.edu go.uvm.edu/ageng

An online version of this publication is available at
go.uvm.edu/generalspinnerguide



CULTIVATING HEALTHY COMMUNITIES

May 2023—v 1.3

Issued in furtherance of Cooperative Extension work, Acts of May 8 and June 30, 1914, in cooperation with the United States Department of Agriculture. University of Vermont Extension, Burlington, Vermont. University of Vermont Extension, and U.S. Department of Agriculture, cooperating, offer education and employment to everyone without regard to race, color, national origin, gender, religion, age, disability, political beliefs, sexual orientation, and marital or familial status. Any reference to commercial products, trade names, or brand names is for information only, and no endorsement or approval is intended.

COLLEGE OF AGRICULTURE AND LIFE SCIENCES

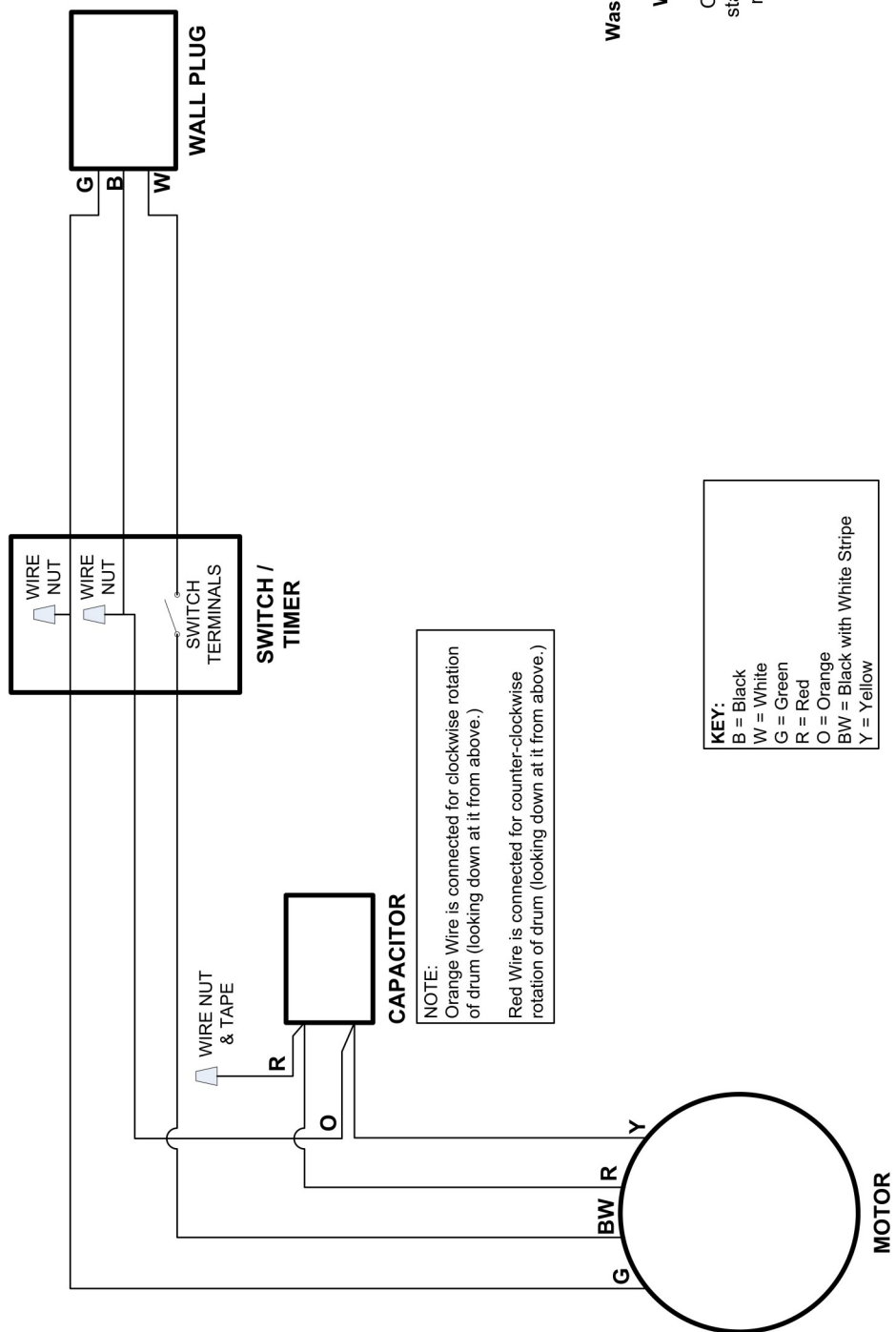

**Washing Machine Conversion
Wiring Guide
Whirlpool WTW500DW**

Observe electrical safety
standards and comply with
national and local code.



<http://go.uvm.edu/ageng>
C. Callahan 2019 10 18